

Report of the Strategic Director, Regeneration and Culture to the meeting of Bradford South Area Committee to be held on 28 January 2016.

V

Subject:

NEW WORKS ROAD, BRADFORD – TRO OBJECTIONS

Summary statement:

This report considers objections received to a recently advertised Traffic Regulation Order for proposed waiting restrictions on New Works Road. The proposals form part of the Low Moor Station development.

Ward:

30

Wyke

Mike Cowlam
Strategic Director
Regeneration and Culture

Portfolio:

Housing, Planning and Transport

Report Contact: Andrew Smith
Principal Engineer
Phone: (01274) 434674
E-mail: andrew.smith@bradford.gov.uk

Overview & Scrutiny Area:

Environment and Waste Management



1.0 SUMMARY

- 1.1 This report considers objections received to a recently advertised Traffic Regulation Order for proposed waiting restrictions on New Works Road. The proposals form part of the Low Moor Station development.

2.0 BACKGROUND

- 2.1 Work to construct a new railway station on land adjacent to New Works Road and Cleakheaton Road at Low Moor commenced in 2015. The proposed car park access is on New Works Road. In order to prevent congestion, facilitate safe access and prevent conflict with local residential parking it is proposed to introduce waiting restrictions and permit parking on parts of New Works Road. A proposed short length of yellow lining also extends into Cleckheaton Road to tie in with the existing solid white line system on the railway bridge. Within the permit parking areas, an allowance of one hour parking for non-permit holders is proposed to maintain some short stay parking for residents' visitors and local businesses. As part of the planning permission, a perpendicular parking area has also been constructed on New Works Road; it is proposed that bays within this area will be for permit holders only.
- 2.2 The proposals are detailed on plan no. TDG/THS/100593/GA-2A, attached as Appendix 1.
- 2.3 The Traffic Regulation Order was advertised between 13th November and 4th December 2015. Affected residents were notified of the proposals by letter during the advertising period. A total of 32 properties were consulted. As a result one letter of objection to the proposals has been received.
- 2.4 A summary of the points of objection and corresponding officer comments is tabulated below:

Points of objection	Officer comments
1. There are existing parking problems on New Works Road due to conflict between residential parking and that associated with local businesses.	1. Officers have visited the site on numerous occasions during the working day and on-street parking adjacent to residential properties here has always been available. The proposals will only serve to improve matters as they will prevent any long-stay non-residential parking.
2. The scheme does not give consideration for parking for residents.	2. The scheme proposes to provide permit parking spaces along the entire residential frontage of New Works Road from nos.2 to 32. In addition a further 7 spaces, in purpose built bays, will be designated to residents.
3. Objects to 1 hour exemption for non-permit holders. Concerned that this will be	3. The 1 hour exemption has been included within the proposal to ensure that short-stay

constantly occupied by visitors to the station or local businesses.	occasional parking for the few small businesses located nearby can continue. Such an exemption would also be convenient for residents themselves as it would be less restrictive for their own visitors. Commuter parking would not be viable within such a short time period. There will be provision within the new station car park for passenger drop-off and pick-up.
---	--

3.0 OTHER CONSIDERATIONS

- 3.1 Local ward members and the emergency services have been consulted on the proposals. No adverse comments have been received.
- 3.2 The proposed highways works associated with the station development also include a ban on HGV's from entering New Works Road from Cleckheaton Road. That has been processed as a separate Traffic Regulation Order and was promoted in tandem with the waiting restrictions Order. There were no objections to the HGV ban.
- 3.3 The planning permission for the station includes provisions for a review of parking in the vicinity of the site when the facility is operational.

4.0 FINANCIAL AND RESOURCE APPRAISAL

- 4.1 The estimated cost of the Traffic Regulation Orders is £15,000. This is being funded by the developer.

5.0 RISK MANAGEMENT AND GOVERNANCE ISSUES

- 5.1 There are no significant risks arising out of the implementation of the proposed recommendations.

6.0 LEGAL APPRAISAL

- 6.1 The options contained in this report are within the Council's powers as Highway Authority and Traffic Regulation Authority.

7.0 OTHER IMPLICATIONS

7.1 EQUALITY & DIVERSITY

Due regard has been given to Section 149 of the Equality Act when determining the proposals in this report.

7.2 SUSTAINABILITY IMPLICATIONS

There are no sustainability implications arising from this report.

7.3 GREENHOUSE GAS EMISSIONS IMPACTS

There is no impact on the Council's own and the wider District's carbon footprint and emissions from other greenhouse gasses arising from this report.

7.4 COMMUNITY SAFETY IMPLICATIONS

The proposed measures would improve road safety.

7.5 HUMAN RIGHTS ACT

None

7.6 TRADE UNION

None

7.7 WARD IMPLICATIONS

All ward members have been consulted on the proposals.

7.8 AREA COMMITTEE WARD PLAN IMPLICATIONS

7.8.1 The development and implementation of proposals included in this report supports priorities within the Bradford South Area Committee Ward Plans 2015-16.

8.0 NOT FOR PUBLICATION DOCUMENTS

8.1 None

9.0 OPTIONS

9.1 Members may propose an alternative course of action; in which case they will receive appropriate guidance from officers.

10.0 RECOMMENDATIONS

10.1 That the Traffic Regulation Order for permit parking and waiting restrictions on New Works Road and Cleckheaton Road be sealed and implemented as advertised.

10.2 That the objector be informed accordingly.

11.0 APPENDICES

11.1 Appendix 1 – Drawing No. TDG/THS/100593/GA-2A

12.0 BACKGROUND DOCUMENTS

12.1 City of Bradford Metropolitan District Council File Ref: TDG/THS/100593

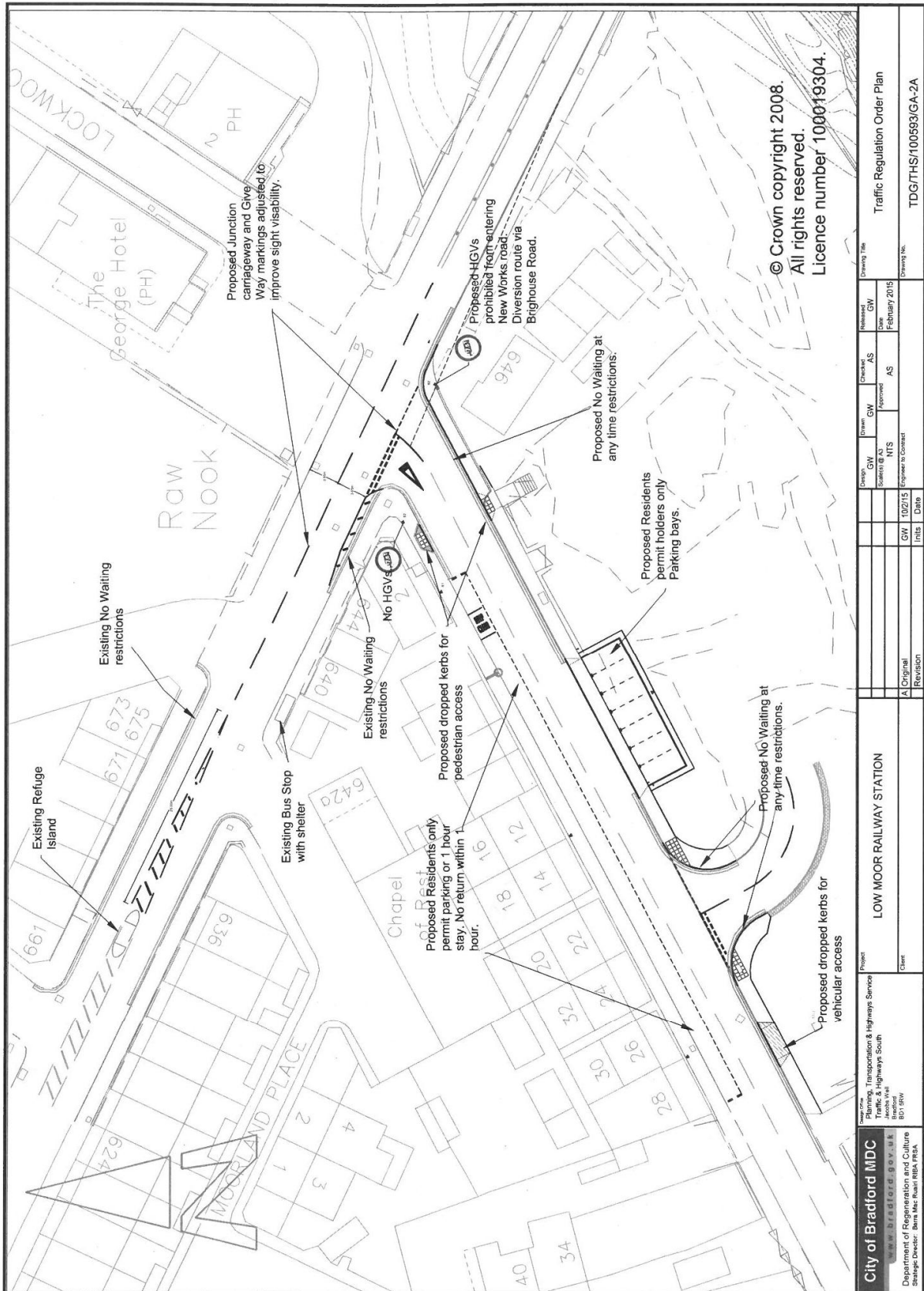

© Crown copyright 2008.
All rights reserved.
Licence number 100019304.

<p>City of Bradford MDC www.bradford.gov.uk Department of Regeneration and Culture Strategic Director: Berni MacRae FRIBA FRSA</p>		<p>Project: LOW MOOR RAILWAY STATION</p>		<p>Client: LOW MOOR RAILWAY STATION</p>	
<p>Prepared by: Planning, Transportation & Highways Service Traffic & Highways South Bradford 801 SW</p>		<p>Drawn: GW Checked: AS Approved: AS</p>		<p>Reviewed: GW Date: February 2015</p>	
<p>Project: LOW MOOR RAILWAY STATION</p>		<p>Drawing Title: Traffic Regulation Order Plan</p>		<p>Drawing No.: TDG/THS/100593/GA-2A</p>	
<p>Revision:</p>		<p>GW 10/2/15</p>		<p>Ints Date</p>	